



## **Meetings & Conferences**

**37 York Place, Perth, PH2 8EH  
Tel 01738 621057 Fax 01738 445363**

[www.grampianhotel.co.uk](http://www.grampianhotel.co.uk)

[reservations@grampianhotel.co.uk](mailto:reservations@grampianhotel.co.uk)

## Conference Rates

Day Delegate Rate £20

Includes room hire

3 breaks with tea & coffee, Scones, Pastries, biscuits

Lunch: choose from working buffet, restaurant lunch, soup & sandwiches

Screen & Projector

Free WiFi throughout hotel

Flip Chart and Pens

## Residential

12 en-suite rooms available on site

## Refreshments

Buffet lunch from £8.95 pp

Tea & Coffee £2.50 pp

Tea & Coffee & Biscuits £2.70 pp

Tea & Coffee & Homemade Scones £3.95 pp

Tea & Coffee & Pastries £3.95 pp



## Room Hire

If you wish to hire our facilities on a room hire basis please refer to the prices below:

Room	DAY (9am-6pm)	EVENING (7pm-Midnight)
Function Room	£400.00	£150.00
Conservatory Small	£100.00	£50.00
Conservatory Large	£120.00	£60.00
Castles Restaurant & Bar	£150	
Dining room	£150	

### Capacities

Function room	120
Conservatory small	10
Conservatory large	24
Castles Restaurant & Bar	40
Dining Room	30

All rates are shown include 20% VAT.



### **Accommodation**

12 En-suite Rooms , non-smoking  
Hospitality Tray  
Direct Dial Telephone  
Hairdryer  
Remote Control Television  
Complimentary WIFI Access  
Personal Toiletries

### **Conference & Banqueting**

Function Suite for up to 170 People  
Private Function Bar  
Fixed Dance Floor  
Air Conditioning in Function Suite  
Conference Equipment  
Conservatory Syndicate area for up to 25 people

### **Bar Facilities**

*Public & Residents Restaurant & Bar*  
Function Bar  
*Can be reserved as private Bar*

### **Guest Facilities**

Room Service Menu  
Lounge Service Menu  
Complimentary WIFI Access

### **Castles Restaurant**

Offers A La Carte menu  
Caters for Special Dietary Requirements

#### **Breakfast**

7.30am – 09.30am Monday – Friday  
8.00am – 10.00am Saturday  
8.00am – 11.00am Sunday

#### **High Tea**

4.30pm – 6.30pm Monday to Saturday  
4.00pm – 7.00pm Sunday

#### **Dinner**

6.30pm – 9.00pm Monday – Saturday

### **Complimentary Car Parking**

9 guest spaces available  
at the front of the hotel

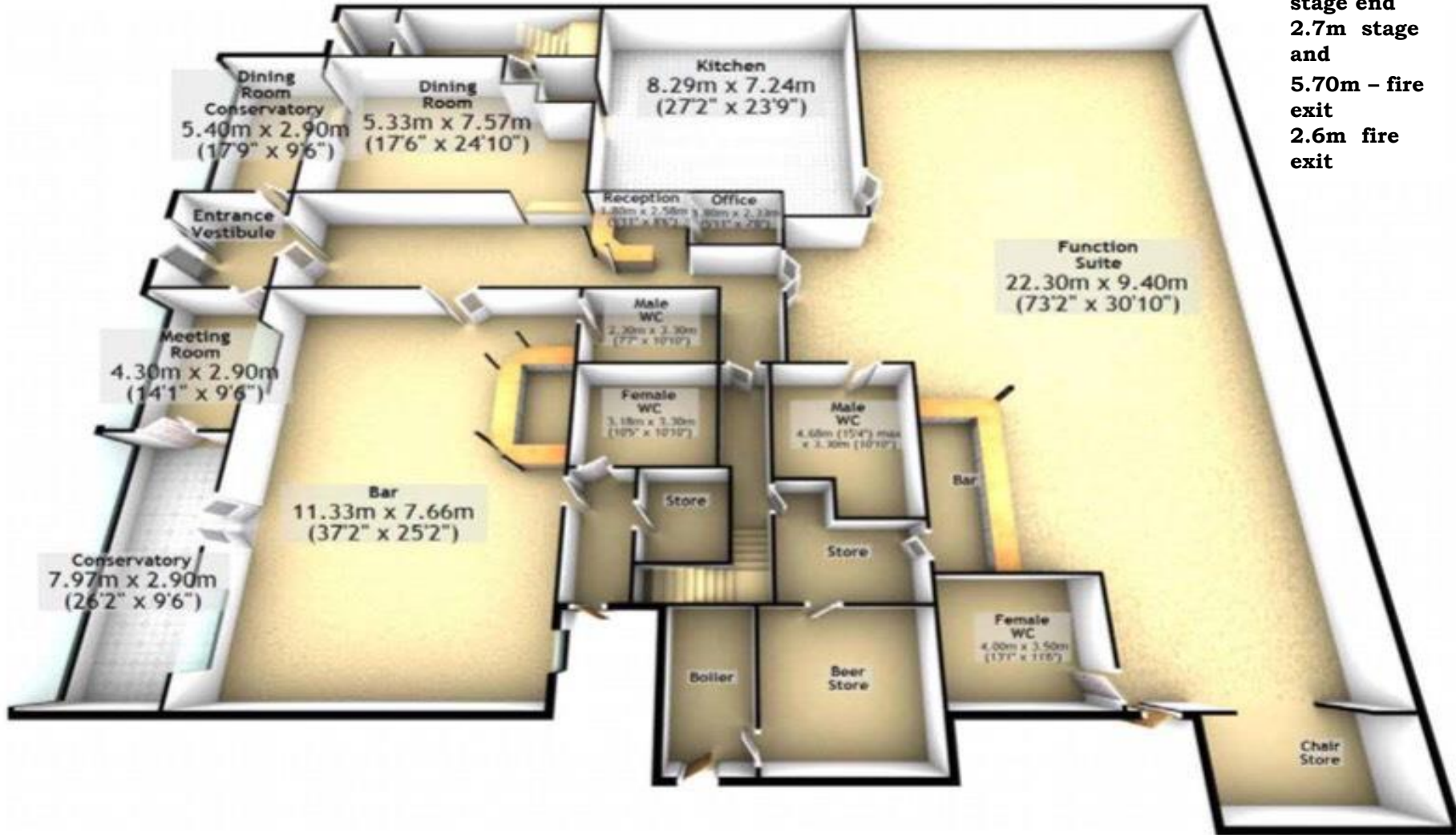

**HEIGHT**

**9.25m -**  
**stage end**  
**2.7m stage**  
**and**  
**5.70m - fire**  
**exit**  
**2.6m fire**  
**exit**



---



**GRAMPIAN  
HOTEL**  
traditional Scottish hospitality



Large Conservatory  
Capacity: 24 Seated



Small Conservatory  
Capacity: 10 Seated

Both the Small and Large Conservatory areas can be used simultaneously, these rooms are located just off the bar and Castles restaurant.  
Capacity: 34 Seated for both small and large conservatory.

---



**GRAMPIAN  
HOTEL**  
traditional Scottish hospitality

**Seating  
Capacity**      **Function  
Suite**

**Theatre  
Style**            **120**

**Classroom**        **80**

**Boardroom**        **25**

**U-Shape**            **25**

**Dinner**             **120**

**Cocktail  
Party**             **170**





## Directions to the Grampian Hotel

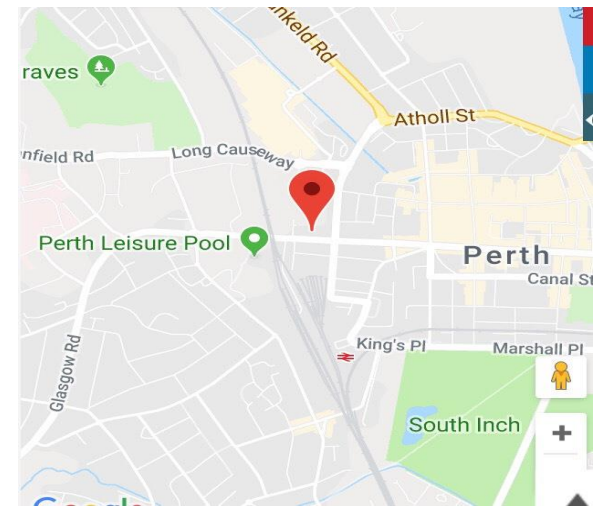

### **From Inverness**

The A9 (Southbound) brings you to Inveralmond roundabout. Take the 1st exit, this brings you into Perth via the Dunkeld Road. Stay on this road until you reach a junction situated adjacent to Tayside Police Headquarters. Take the exit to the right on to Caledonian Road. Cross straight over roundabout, through the 1st set of traffic lights, then right at the next set of traffic lights. The Grampian Hotel is the second building on the right hand side.

### **From Dundee**

The A90 brings you into Perth down the Dundee Road. As you pass the Isle of Sky Hotel, prepare to turn left on to the Queen's Bridge. Exit the bridge to the left, take the first on the right on to Canal Street. At the end of this street take a right on to King Street. At the junction take a left on to County Place. Pass straight through traffic lights, the Grampian Hotel is on the right hand side.

### **From Edinburgh**

The M90 brings you into Perth via the Edinburgh Road, passing Tesco Supermarket and the Prison on the right hand side. As you reach the end of the South Inch Parkland, take a left on to Marshall Place. Take the 4th right on to King Street. At the junction take a left on to County Place. Pass straight through traffic lights, the Grampian Hotel is on the right hand side.

### **From Glasgow**

The A9 (Northbound) brings you to Broxden roundabout. Take the second exit, bringing you into Perth down the Glasgow Road. Follow this road, passing the Dewars Ice Rink and Leisure Pool on the right hand side. Cross the railway bridge and the Grampian Hotel is on the left hand side.